

7:00p - 5:30p
7:40 - 8:45

RENT-A-SPY
RentASpy. z8
by John Erickson

John Jane O'Connor, employed by Rent A-Spy, to check out memory review
- get used, find info abt what they're doing + who's paying

[On the rd] rd N to gate, S-E rd, small path E. i { - }

e [Small path] shed to N, pile of junk, ~~pile~~ ^{heap} of sand, path continues E to forest
search pile (wire/lockpick) search heap (-) x shed (locked)
unlock shed - wire in [Tool Shed] crate (closed) open crate (sack)
x sack. take it. open it (cont?) e (to dark)

w [On rd] n [Outsd main gate] two guards outsd, + more small bushes

x guards in car x (truck arrives at gate, driver checks papers, gate opens, truck drives in)

z [On rd] x rd (asphalt) put sack on road (truck hits sack) enter truck (+S)

fill sack w sand

truck enters special tunnel, then labyrinth, driver leaves out

[Under parking garage] gateway W, garage E, truck

x gateway (leads to surface, no control to open) e [Upg (E)] metal door + panel

x panel (some buttons are dented) x buttons (2, 4, 6, and 7 are oily)

type 2467 on panel (opens +S) open door. N. [Corr] lamp,

N (metal detector + note) locker in E

read note (no metal in complex! leave them in locker in)

x detector (wide as car + almost as high) e [Locker Rm] lockers, hand, shower N

search clothes (keys) N (Shower Rm) wet floor (E to same, then north)

x thermometer (80°C) x keys (keys to truck)

unlock truck - keys in. Open glove compartment (screwdriver, lunchbox)

x lunchbox (plastic - red lid) put keys back

throw screwdriver over detector. throw wire over detector. N. [Corr] ^{N is} ability, take all

n. [Blue lobby - 3rd basement] elev to N, btn, stairs up

N [Elev at floor B3] panel, card slot x panel (this: B1 - Medical lab,

B2 - Admin, B3 - Garage)

U [Elev - 2nd Bf] corr W (stairs) w [Corr] door W (open 9am-5pm)

unlock door - wire (+S) w [Office corr] plant in pot, oil painting, some N+S, corr W.

x plant. x pot. x soil x potted.

N [Corr Rm] copying machine - paper stuck. open machine (paper)

x paper (order for more office supplies, signed by Amy Bird)

S [Secretary's office] desk, ^{rose} roses, computer, monitor, keyboard.

turn on computer (needs password)

Hilroy

family of Bird

look under keyboard (yellow note) read note "I have a head & a tail, but no body."

What am I? Coin? type coin on keyboard (+5)

type Bird / Miss Amy Bird / Secretary and Personal Administrator / B: Apr 11, 1968

Family: husband Steven, daug Brilly & Jennifer.

put note under keyboard.

W [off coin] another oil, in N+S x oil (sign) x sign (Christopher Columbus - Santa Maria sails off Hispaniola)

N [Office Supply] 6 pencils, 4 erasers, 7 paperclips, floppy disc - x disc (3.5")

S [huge office] painting, carpet, desk, safe x painting (sinking Titanic) x carpet (metal) x desk (no drawers) x safe (read combo or stethoscope)

intel elevator at B2, open doors - screwdriver at B3 (cut enter shaft)

enter roof at B2 [Elev roof] cable, hatch, open hatch.

D. push B2. v. open doors with screwdriver. S. [+5]

[Elev lobby - 1st B f] lab-w (med lab 4) table {funnel, 2 flasks, rubber tube, rock (5 test tubes)}

office N, another lab-w

x funnel (top 5cm, bottom 7cm) x glass flasks (1 room)

x rubber tube (inner diam 6 or 7mm, 45-50cm long) test tube (B2nd)

N [Office] diagrams, charts, desk, old book, computer, monitor, keyboard

x old book (in latin, "Dr Ivan Savage")

W [med lab 2] machine, air vent on N wall above machine. (vent - my beaklets entered)

stand on machine (decide to short)

on ~~the~~ Secretary's computer: type bird on keybd.

Dr Ivan Savage / Head of research: Biological warfare specialist.

B: Aug 21 1947, Family: wife hiza & son David

on Ivan's Computer: type david on keyboard (+5)

- producing biological weapon A22-Z. Insert floppy

put disc in drive.

put funnel in tube. (stethoscope) / open safe [+5] x letter (from minister of defense!) copy letter (in copy room)

put original letter in safe. close safe. lock safe

take funnel from stethoscope take book put book on machine. stand on book.

enter vent [vent] (S, W, S)

desk, engplower

bench desk

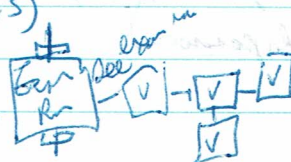

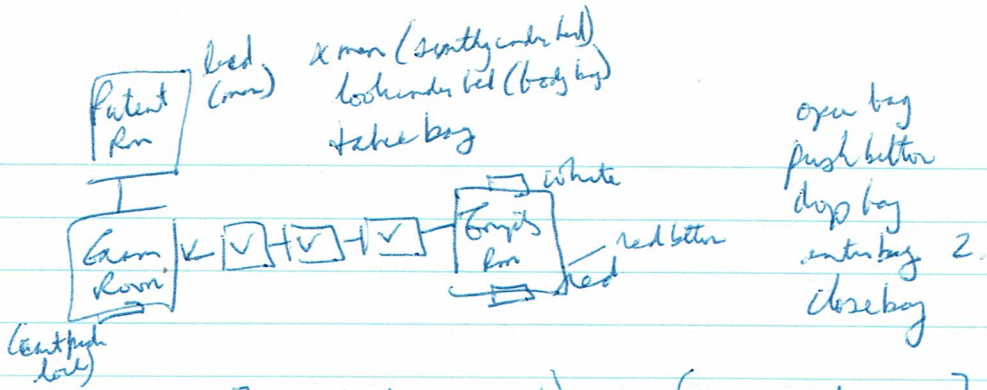

[The truck body bag] open bag (zipper slash!) g.g. [Morgue Refrigerator] / oops - forgot to close not to do
 search (hatch) open hatch (can't reach it)
 open hatch. kick hatch (+S) take bag. close hatch
 in [this] open door. e. [out of morgue] close door. trunk to N, great, barrels N6
 throw line at barrels (black) throw searchlight at barrels (black)
 enter truck (win)

outside B3 + B2 + B1 + V + E
 4 + 9 + 8 + 4 + 12 + 2 = 39

R6J7-A-SPY

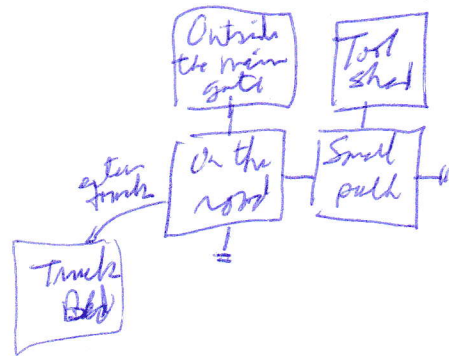
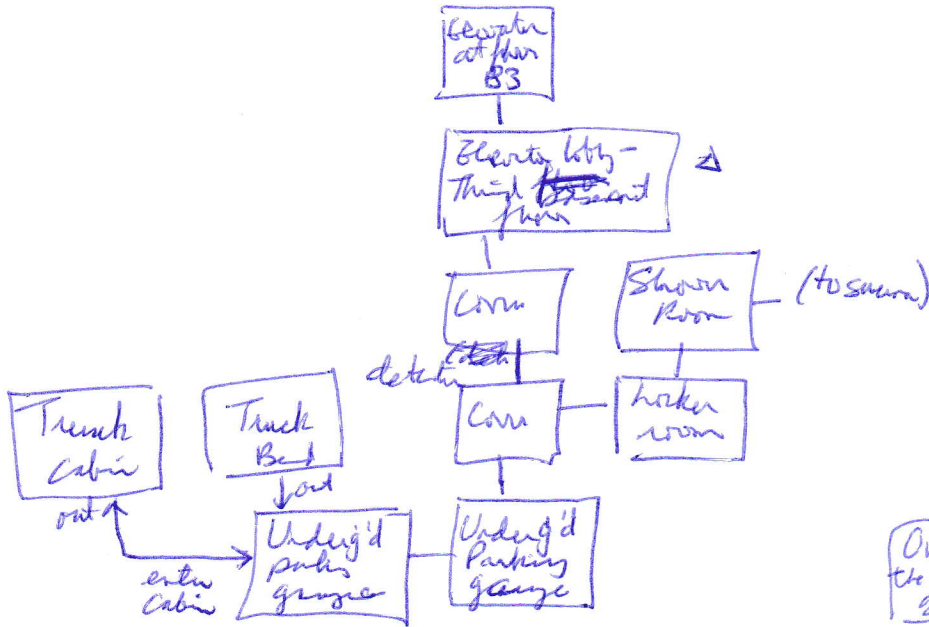
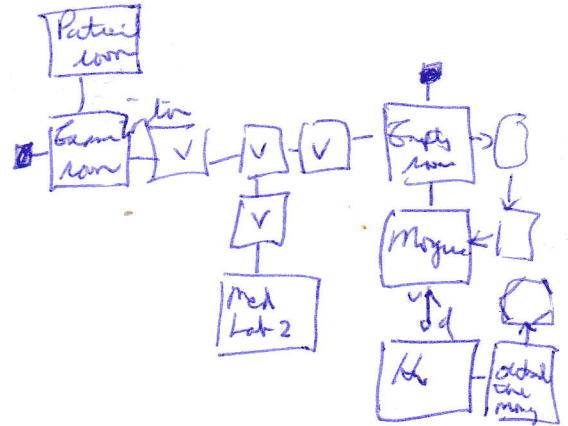
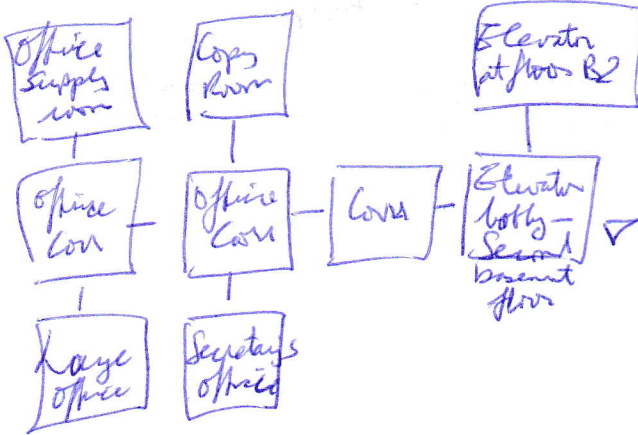

66
 40
 106

